



127 Lord Street NEWTOWN NSW

2 1

127 Lord Street Newtown

This warm and inviting Victorian semi is a real surprise package. Beautifully presented and positioned to perfection with King Streets cafes scene within easy reach this polished gem delivers a lifestyle of immediate quality and class along with value adding options to further enhance and extend. Beyond its pretty frontage the homes inviting interior comprises elegant living room with reverse cycle air conditioning and polished parquet floors, stylish kitchen with stainless steel appliances including dishwasher and gas cooker, the converted attic space is perfect as a home office/study or added storage. Delightfully large bathroom with combined bath & shower and adjoining separate WC, the main bedroom includes built-ins. From the spacious dining room French doors lead to a sundrenched sandstone paved side and rear garden with undercover outdoor area perfect for weekend entertaining. The rear garden further boasts a separate detached studio (second bedroom) perfect for working from home or handy visitor accommodation. The location is sublime with Train Station and Sydney Park just minutes away, this is near city living at its best.

Land Size: 148 sqms approximately

Price : \$ 1,241,000

View : <https://www.planetproperties.com.au/sale/nsw/inner-west/newtown/residential/house/3939224>



Rosalie Gordon
0416198261



Mark Gordon
02 9747 8888

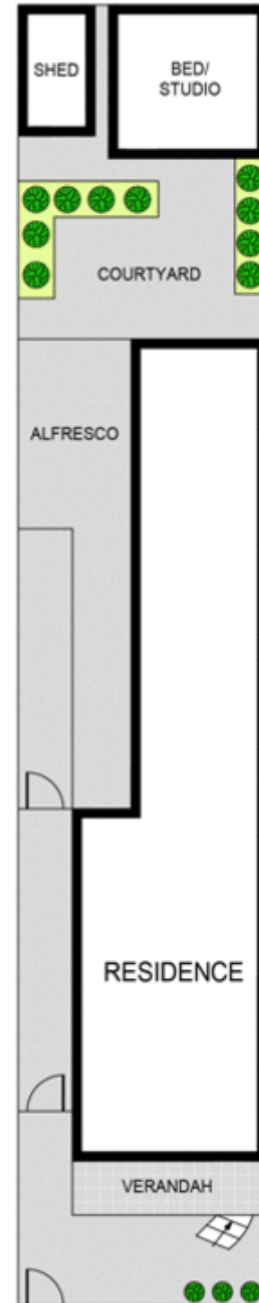
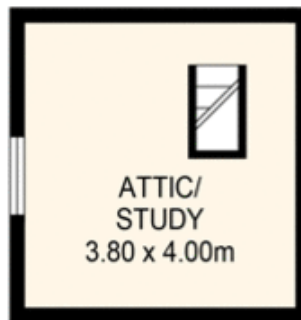
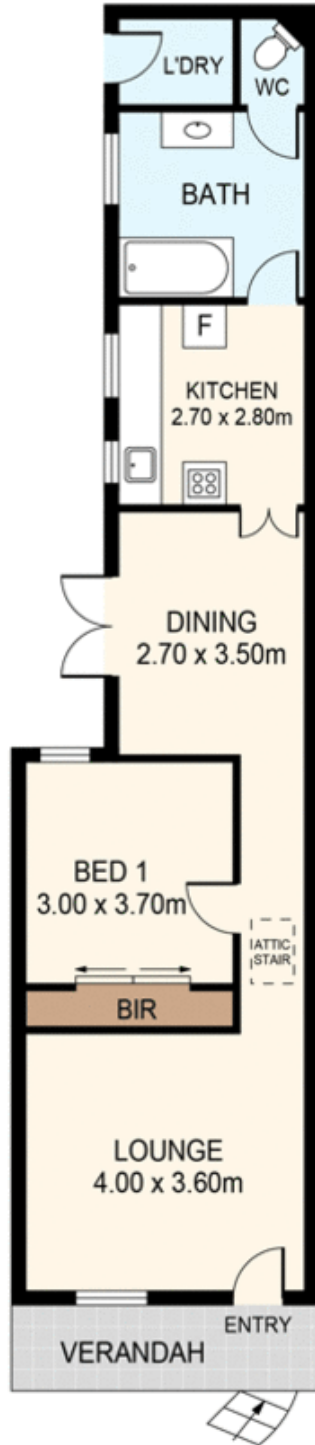
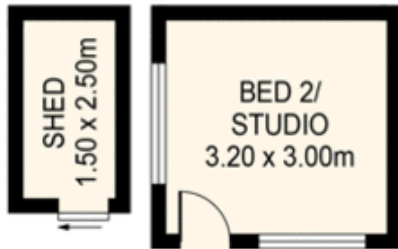

SITE PLAN
(NOT TO SCALE)



DISCLAIMER: THIS IS FOR ILLUSTRATIVE PURPOSES ONLY.
ALL DIMENSIONS ARE APPROXIMATE AND IT DOES NOT
CONSTITUTE PART OF ANY LEGAL DOCUMENTS.

ADDRESS:

127 LORD ST, NEWTOWN